



# GT-I9100 Ice Cream Sandwich (ICS) Guide for Customers

Customer Consultant Guide  
Android mobile  
technology platform

Version 2.0  
Global CS  
ECC HHP review  
16<sup>th</sup> March 2012

Country : Europe  
Language : English

**SAMSUNG**

# Revision History: This version **replaces all previous versions**



Date	Version	Comments
2012.02.19	V1.0	Initial version
2012.02.20	V1.2	Add Home screen (P.2) and Face unlock (P.30)
2012.02.29	V1.3	Add FAQs (P33 and P34)
2012.03.-5	V1.4	Delete Home screen (P.7)
2012.03.12	V1.5	“not available FOTA “ is deleted (P.33) “Device Encryption” issue is added (P.33)
2012.03.16	V2.0	ECC HHP review of V1.3 /1.4 & 1.5 from CS team HQ – ALSO advice taken from Galaxy S2 upgrade rev 1.2 used for advice added to the section on <b>“How to obtain the ICS update for the GT-I9100”</b> <b>Slide 2</b> – Notice with regard to use of GT-I9250 guides for further information <b>removed</b> as this is a GED (Google Experience device) and subsequently different to the GT-I9100 implementation of ICS. <b>Slide 3 and 4</b> added for additional document version history and future updates <b>Slide 7</b> – Introduction to guide added <b>Slide 8</b> – advice regarding Upgrading GT-I9100 from Gingerbread to ICE cream sandwich brought from end of presentation to the beginning (This slide item removed by HQ in Ver. 1.5 – now restored to Ver. 2.0 by ECC HHP as still relevant) <b>Slide 9</b> - FAQ – Bluetooth 3.0 HS & Adobe flash brought forward and added to “Observations regarding the update “section <b>Slide 10</b> – UPDATE via KIES – using Exchange Server account advice added by HQ <b>Slide 13</b> – Additional slide added regarding Set up wizard added due to differences between Generic and implemented ICS updates for GT-I9100 <b>Slide 14</b> – extra text & pictures added regarding <b>“Touch and hold on the bar at the top of the screen and then drag down to Reveal the drop Down menu / notification panel”</b> <b>Slide 19</b> – added slide regarding IME – Input Method Editor <b>Slide 23</b> – section <b>“Text selecting options”</b> expanded to 3 slides with additional material added to describe how to use chare text function using Messaging <b>Slide 28</b> – “Save contact to” slide simplified

# Revision History: This version **replaces all previous** versions



Date	Version	Comments
2012.03.16	V2.0	<p><b>Slide 29</b> – additional text and notes added for “<b>Contact, Logs Icons now removed</b>” slide</p> <p><b>Slide 30</b> – “Unknown sources” option is moved from Applications to Security” slide updated with additional text in the Gingerbread section</p> <p><b>Slide 34</b> – Additional text added for process to access the Display Settings</p> <p><b>Slide 35</b> – Additional text added for process to access Manage Applications</p> <p><b>Slide 36</b> – Additional text added for process to access Manage Applications</p>

# Revision History: This slide reserved for future versions



Date	Version	Comments

# Use of OUTLINE feature of FAQ guide



**Slides Outline**

- 7 Spec: Notice
- 8 Spec: Overview (1/2)
- 9 Spec: Overview (2/2)  
Note:  
PLEASE ADD HERE ANY INFORMATION REGARDING:  
1. BLUETOOTH PROFILES  
2. FILE FORMATS COMPATIBLE with VIDEO PLAYER AND MUSIC PLAYER  
3. BROWSER TYPE used  
4. (add additional slides if required)
- 10 Spec: Battery usage (1/2)  
Note:  
Continuous usage time
- 11 Spec: Battery usage (2/2)  
Note:  
Battery life durations specified on our products are tested in labs under multiple different conditions and the talk and standby times are a realistic average maximum dependent on customer usage variables.  
  
Some variables that may affect battery life are:  
  1. Backlight settings set to always on, or a long amount of time
  2. Using Internet Services including Text Messaging
  3. If you tend to be in a "weak" coverage area where your signal strength meter shows only 1 to 2 bars
  4. Using non-SAMSUNG charging accessories can affect battery life and other issues, as well as void the manufacture's limited warranty.
- 12 Spec: How to Check handset software / Hardware information  
Q : How do I check the Software / Hardware version on my phone?  
  
A : To check the software/hardware version follow the steps below:  
  1. While in standby mode, tap Applications.
  2. Select Settings.
  3. Select About phone.
  4. Select Status.
  5. Scroll down to view phone information.
- 13 FAQ Area 2 / Device - Physical Layout & Initial Setting up  
Device - Physical Layout & Initial Setting up

## Device: Layout / Front

The diagram shows the front view of a mobile phone with the following components labeled:

- Earpiece
- Volume key
- Multifunction jack
- Light sensor
- Proximity sensor
- Front camera lens
- Touch screen
- Mouthpiece

In this FAQ guide, all slides have been titled so that slide name appears in the Outline Tap.

When using the guide open the Outline Tap and scroll up / down to help find the area you require

# Spec: Notice

**Notice:**

All functionality, features, specifications and other product information provided in this document including, but not limited to, the benefits, design, pricing, components, performance, availability, and capabilities of the product are subject to change without notice or obligation. Samsung reserves the right to make changes to this document and the product described herein, at anytime, without obligation on Samsung to provide notification of such change.

# Introduction to this guide



**Introduction: Ice Cream Sandwich - “ICS” (Android OS 4.0) upgrade for GT-I9100**

**This guide has been created to provide advice on:**

- > How to obtain the ICS update for the GT-I9100**
- > Observations regarding the update**
- > Advice regarding some of the key differences between Gingerbread OS and Ice Cream Sandwich OS**

# How to obtain the ICS update for the GT-I9100



**Q. Can I upgrade my phone to Android SW version “Ice Cream Sandwich” (ICS) via FOTA?**

- A. The ICS SW upgrade is **not currently** supported via FOTA.  
When the ICS upgrade becomes available to upgrade your GT-I9100 to ICS version, please upgrade your mobile via **KIES 2.0**  
You can download KIES 2.0 from [www.samsung.com](http://www.samsung.com)

⌘ **Note:** If the customer tries to upgrade the mobile device SW from **Ginger Bread** to **Ice Cream Sandwich** via FOTA, a “No update available” pop-up will be displayed.

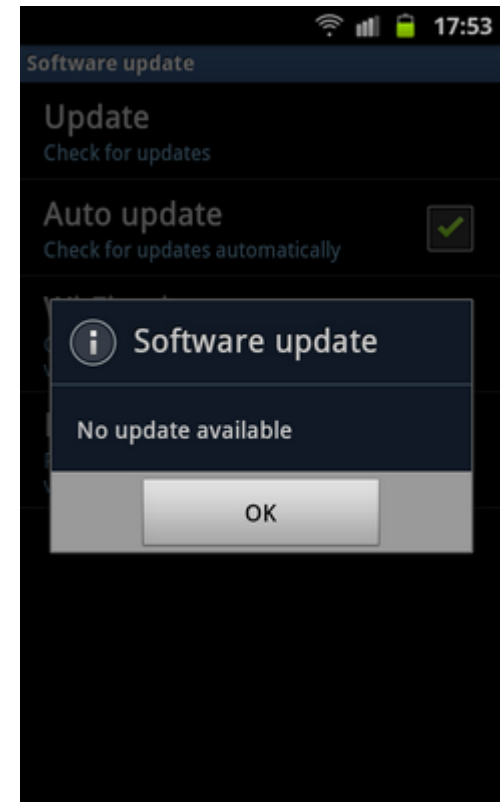



# Observations regarding the update 1/3



**Q. Can I use Bluetooth 3.0 HS function in ICS version?**

A. The Ice cream Sandwich OS feature does not support **Bluetooth 3.0 HS** (High Speed) function

However **Bluetooth 3.0** is supported.

If you want to transfer a file at a faster data rate between devices, you can use Wi-Fi direct function. (where the other device supports this function)

**Q. Can I see Adobe flash contents in web browser?**

A. **No** - To view compatible Adobe Flash contents of a web page, please download Flash player from Android “Play Shop” (Previously known as Android market).

# Observations regarding the update 2/3



**Q. I use the exchange server account in my mobile and can not upgrade its OS to ICS through Kies.**

**A.** Some exchange server account requires the “device encryption” to connect to exchange server.

“Device encryption” limits the synchronization or firmware updating through Kies.

Please decrypt or initialize your mobile after data backup and try to upgrade again.

# Observations regarding the update 3/3



## Notes regarding initial differences and settings after ICD update

### ICS (v4.0)

#### ⌘ Wall paper and Widgets

The **Wall Paper set prior to ICS update** will revert back to the “default” setting

The **Widgets set prior to the ICS update** will be initialized

#### ⌘ Application compatibility

- Some 3<sup>rd</sup> applications will not work in ICS OS
- If so, please advise customer they will need to advise 3<sup>rd</sup> party application developer that an update to the app is required.

# Setup Wizard 1/2

## Gingerbread (v2.)

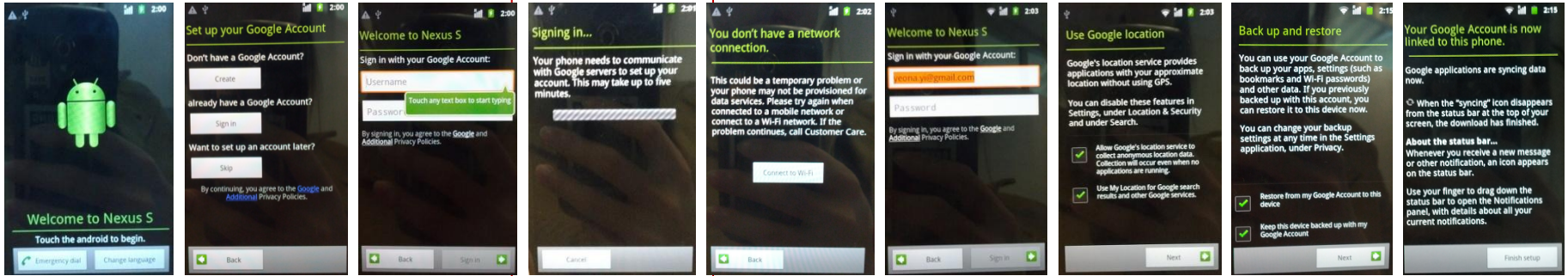

Select language

Select Google Account Sign in

Google Account Sign in

Sign in fail

**This STEP now removed**

Connect Wi-Fi

Google Account Sign in

Location Service Agreement

Backup & restore Agreement

Setup completed

## ICS (v4.0)

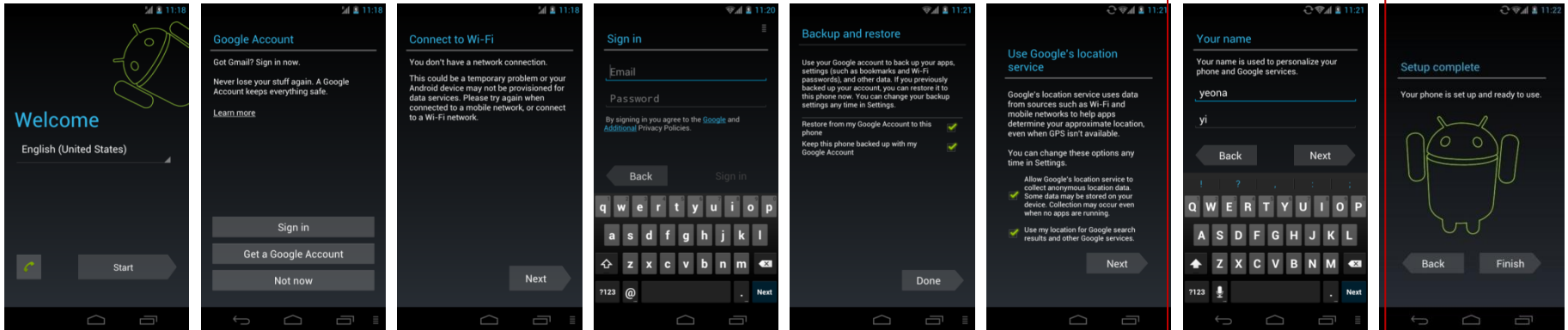

Select language

Select Google Account Sign in

Connect Wi-Fi

Google Account Sign in

Select Backup & restore

Location Service Agreement

Input user name

**This STEP Added**

Setup completed

# Setup Wizard 2/2



**Note:** The previous slide shows the Set Up wizard pictures for a Generic ICS update.

**Be advise that the Set Up wizard may vary depending on region.**

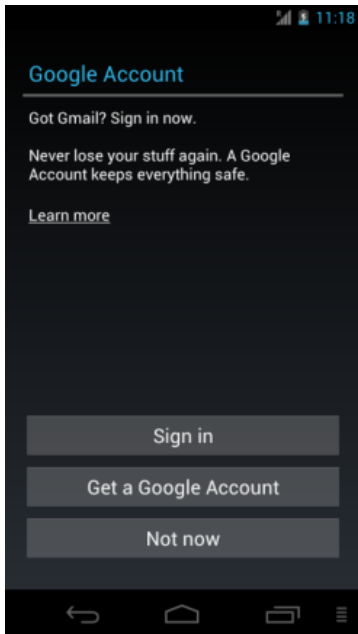
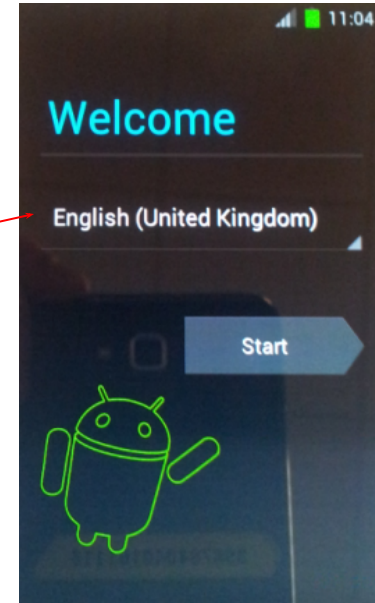

**GOOGLE ACCOUNT:**  
Generic ICS setup wizard showing screen for setting up Google account

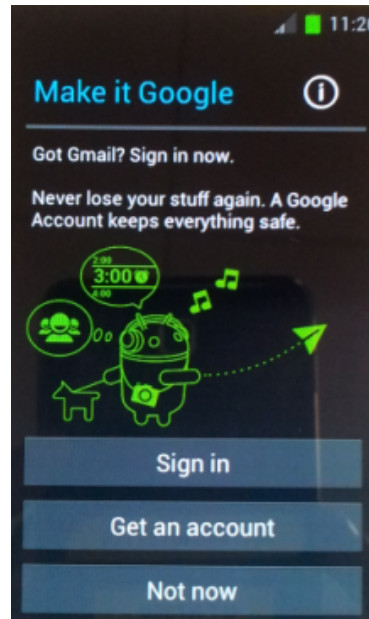

**MAKE IT GOOGLE:**  
GT-I9100 ICS setup wizard showing screen for setting up Google account

# Samsung Account



※ “Samsung Account” Icon now added in notification panel\*



ICS (v4.0)

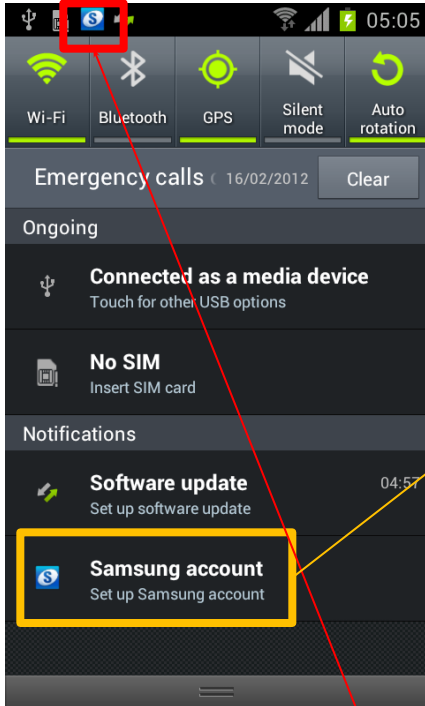

The Samsung Account notification icon is displayed after S/W upgrade or initialization

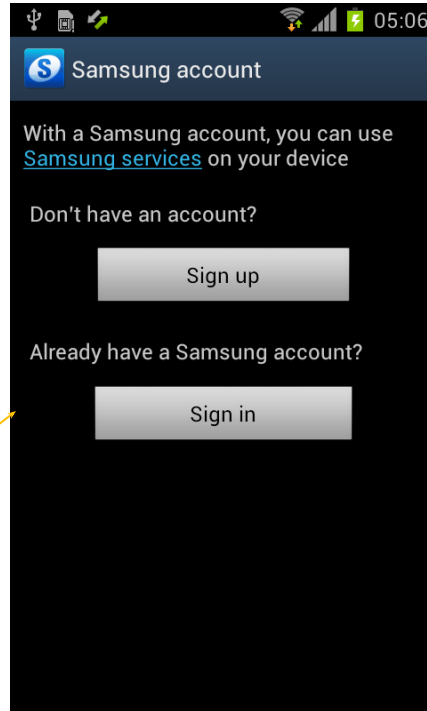

If you tap on the “Back” button when in this screen, the Samsung account icon will not display in notification bar

## Samsung Account

A Samsung account is used for identify the user with regard to Samsung services such as Samsung Dive

**Note:** A Samsung Account is no longer required for the Samsung FOTA service

\*Touch and hold on the bar at the top of the screen and then drag down to reveal the drop Down menu / notification panel

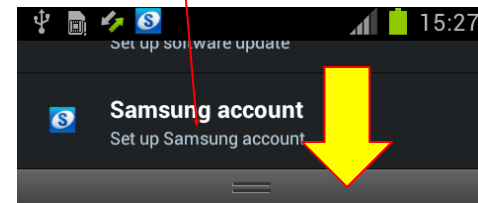

# Home Screen – FOTA Service



※ “Software update” Icon now added in notification panel

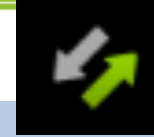

ICS (v4.0)

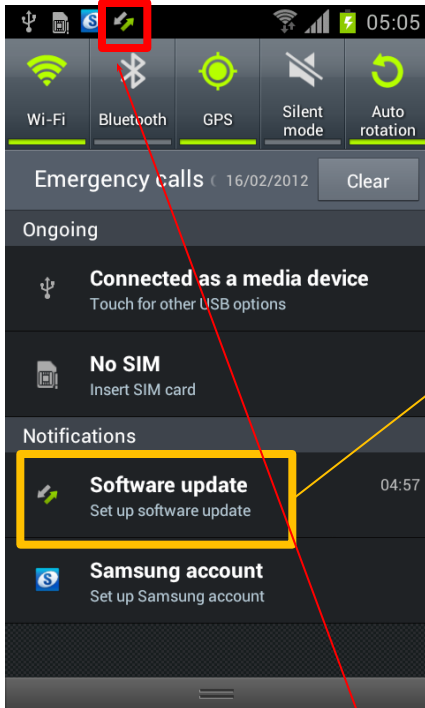

The Software update notification icon is displayed after S/W upgrade or initialization

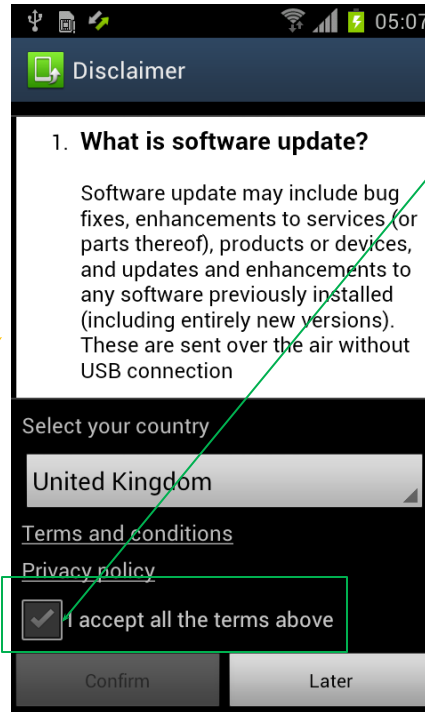

If you confirm this disclaimer, Notification icon will be disappeared.  
※ If you tap on “Later”, the screen it will change.

## Samsung FOTA Service

If you accept “Disclaimer”, your mobile will check S/W version in Samsung server and update to latest version where available.

**Note:** A Samsung Account is no longer required for the Samsung FOTA service

# General – Menu Button (1/2)



✂ Sub menu for Menu Button is changed

Gingerbread (v2.3.6)

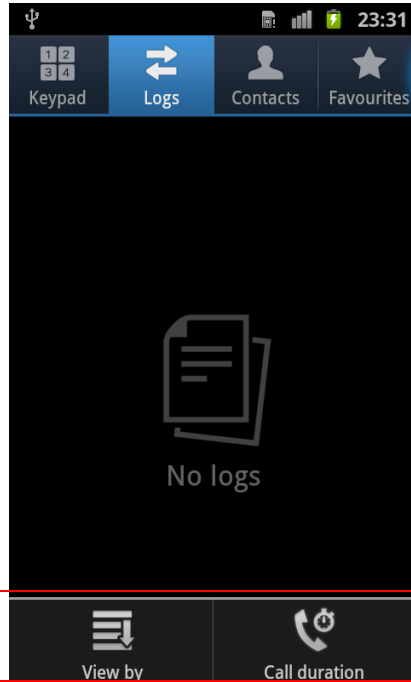
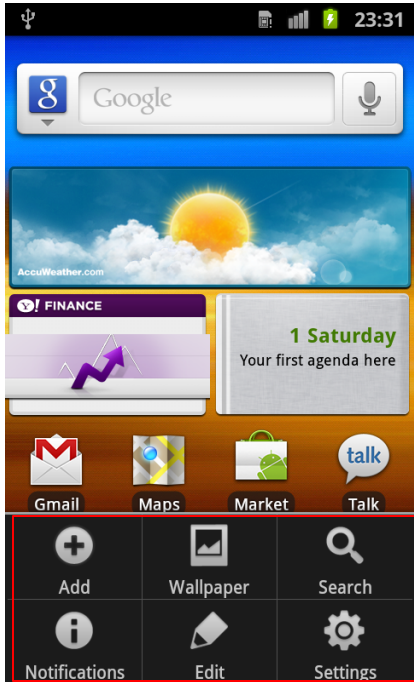

ICS (v4.0)

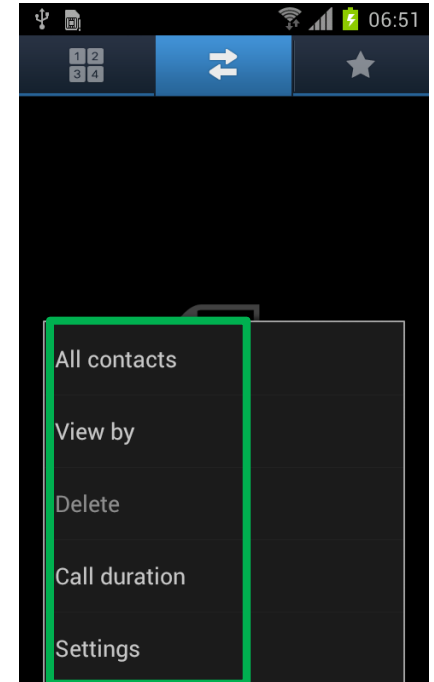
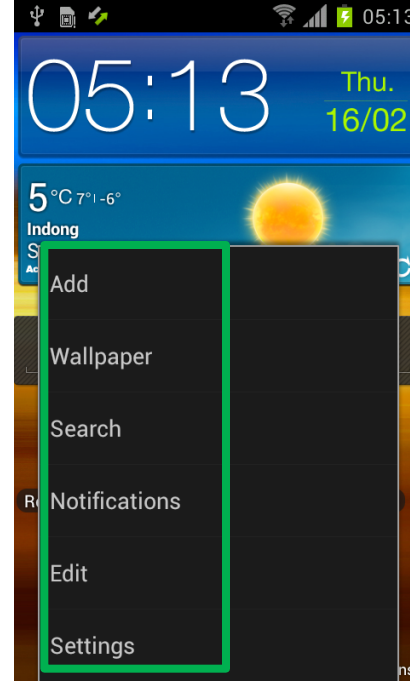

Grid format Sub menu for Menu Button

Changed to

Sub menu for Menu Button is changed from Grid format to **List** format



# General – Menu Button (2/2)



✂ Sub menu for Menu Button is changed

Gingerbread (v2.3.6)

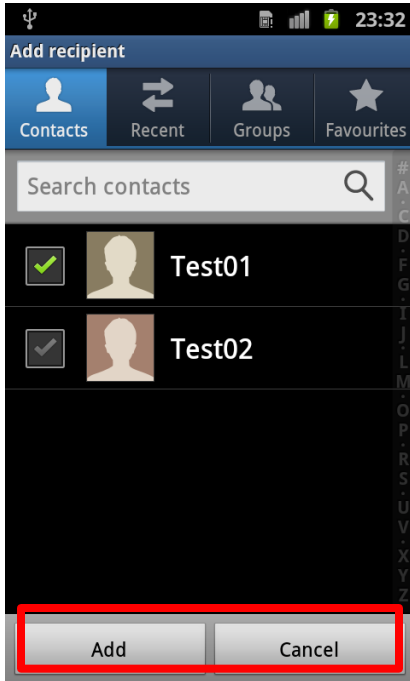

**Add** and **Cancel** located at the bottom of the screen

ICS (v4.0)

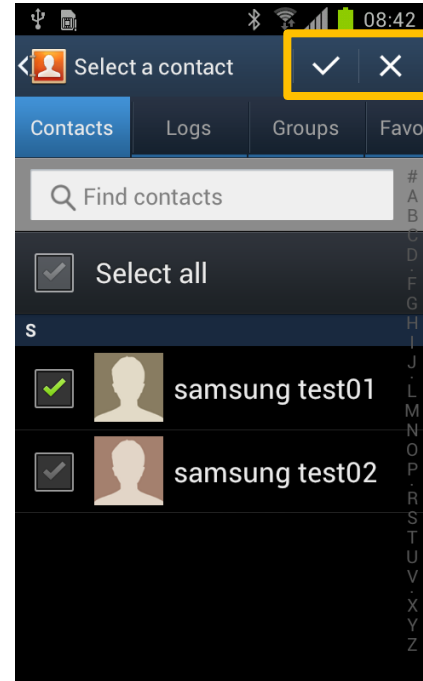

**Add** and **Cancel** located at the top\* of the screen

Changed to

\*Many buttons( like “Add”, “Cancel”) are now moved from bottom of screen to the top

# General – Input Method 1/2



✂ How to select Input method process is changed

Gingerbread (v2.3.6)

ICS (v4.0)

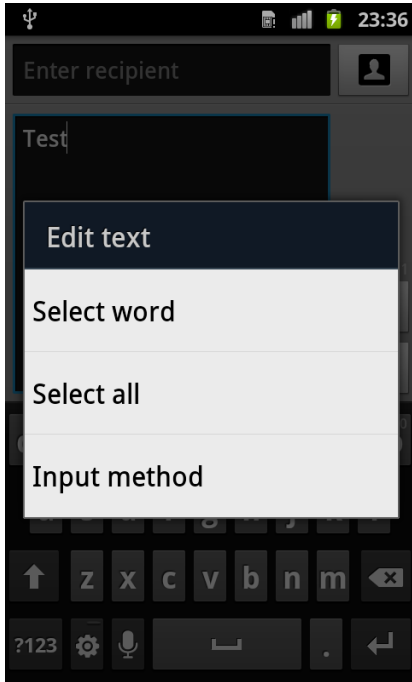

Click and hold in "Input screen"

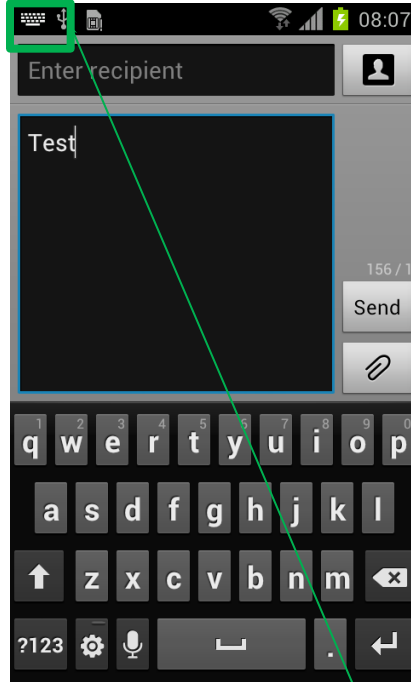

1. Keyboard Icon is added in indicator bar

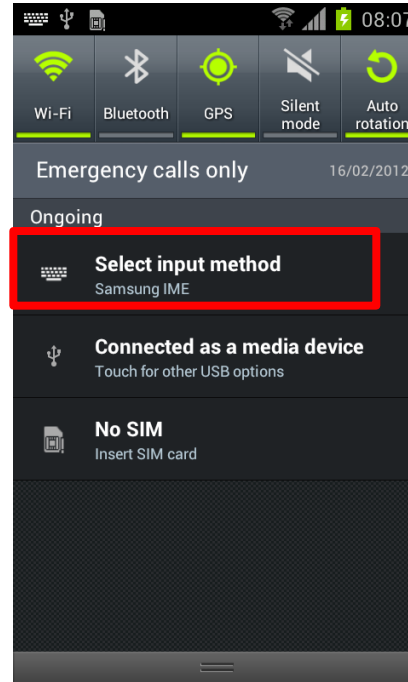

2. Select "Select input Method" (drag down the Notification screen first)

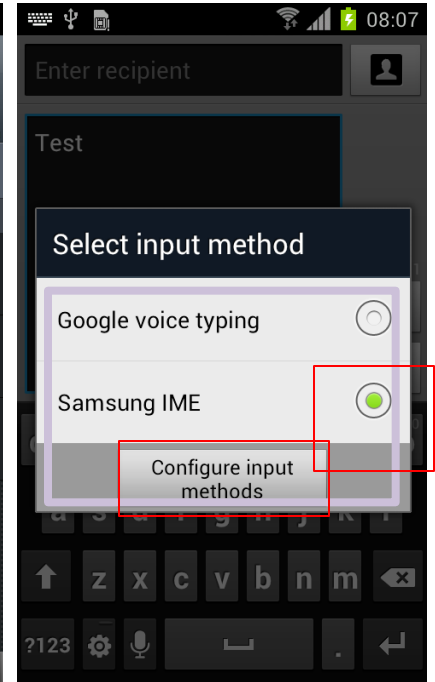

3. Change or configure input method

**SEE NEXT SLIDE**

Changed to

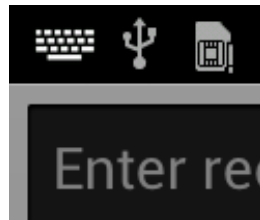

# General – Input Method 2/2



ICS (v4.

8)

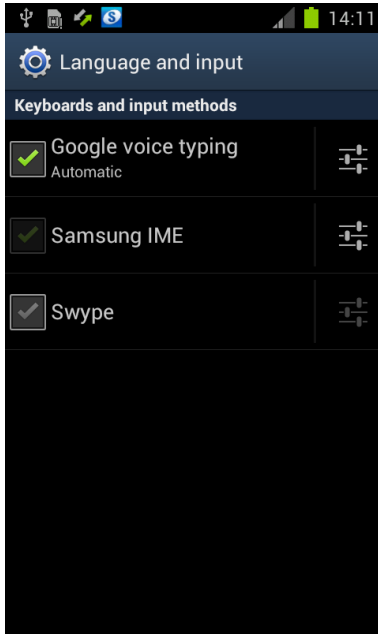

4. Tap in the settings icon box next to Samsung IME\*

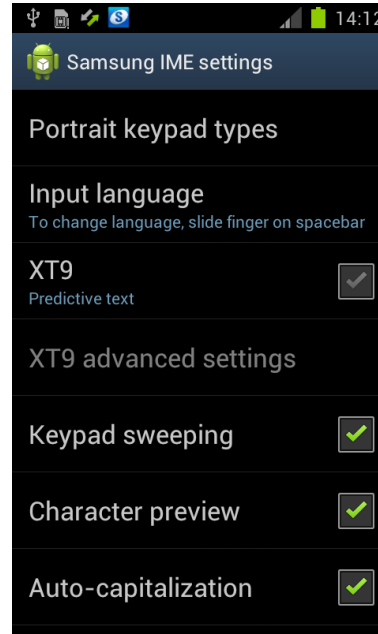

5. You can now configure the Samsung IME settings

\*IME – Input Method Editor

# General – Power



✂ “Restart” now added

Gingerbread (v2.3.6)

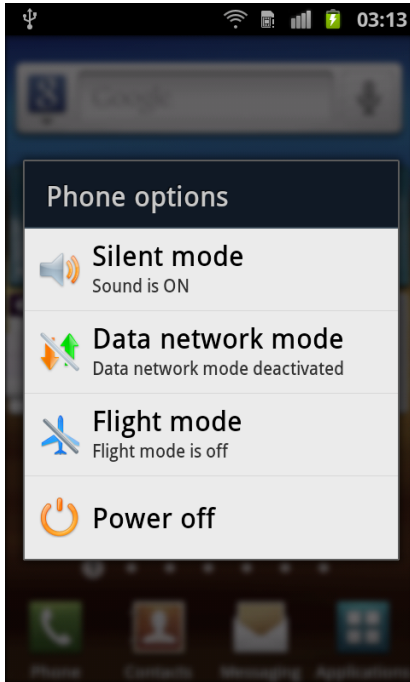

Options shown when you press power button for a few seconds

ICS (v4.0)

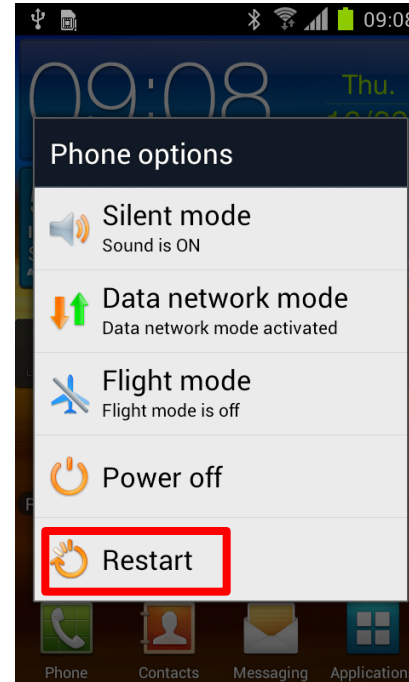

“Restart” option is added when you press power button for a few seconds

Changed to



# General – Slide Lock



✂ To unlock slide lock, touch and drag to outside of circle

Gingerbread (v2.3.6)



To unlock slide lock, touch and drag “Lock screen”

ICS (v4.0)

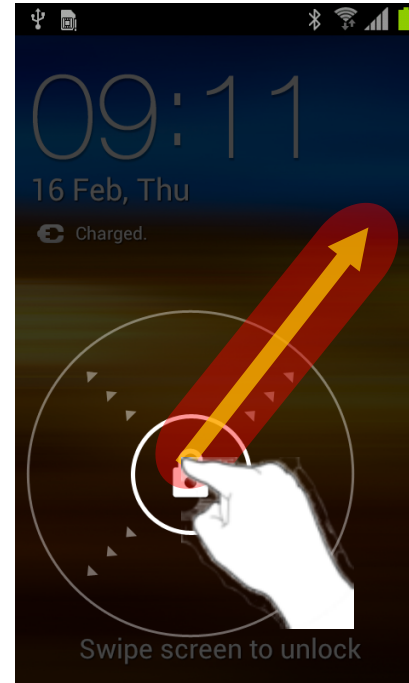

To unlock slide lock, touch and drag to outside of circle

Changed to



# General – Recent

✂ Recent application display UI is changed

## Gingerbread (v2.3.6)

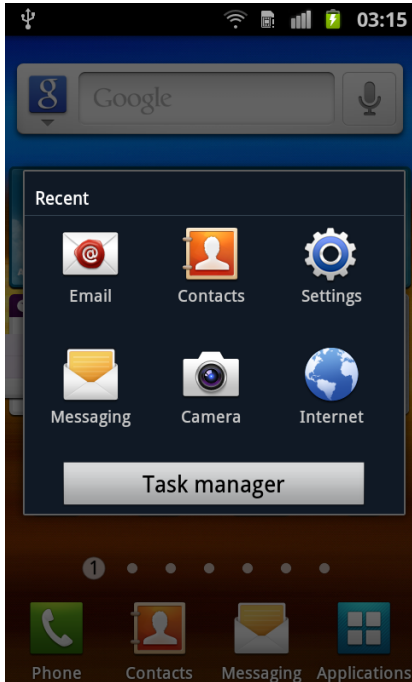

If you press “Home” button for a few seconds, recent applications are displayed.

## ICS (v4.0)

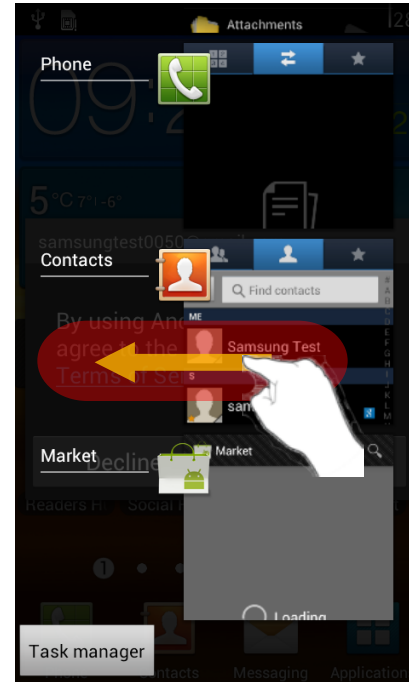

If you press “Home” button for a few seconds, recent applications are displayed.

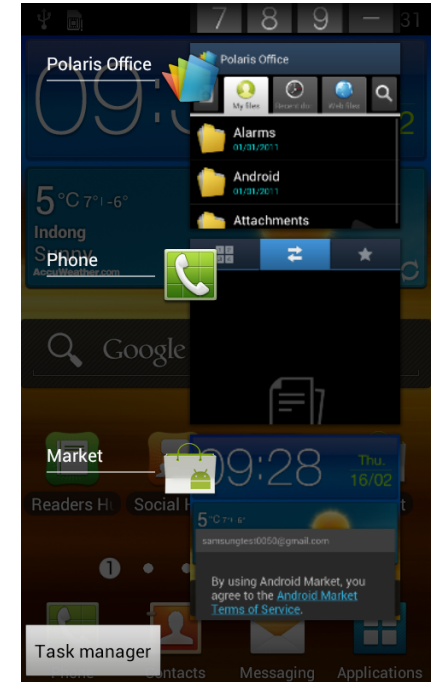

If you want to remove an application in recent list, select and drag to right or left side

Changed to

# General - Text Selection 1/3



✂ Text selecting options are moved to the top of screen

ICS (v4.0)

Example below shows Text selection when using WEB browser

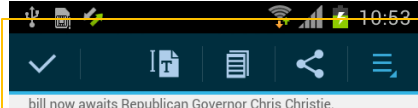

By Jason Method, Asbury Park (N.J.) Press  
Published: 2/16/2012 8:22:24 PM

TRENTON, N.J. -- Proponents spoke about faith, tradition and history Thursday before passing legislation in the New Jersey state Assembly that would allow same-sex marriage and sending it toward inevitable confrontation with Republican Gov. Chris Christie.

Even with the outcome certain, Assembly members debated for more than two hours over the measure. Overwhelmingly, Democrats took to the floor to declare that the chamber stood at a crucial moment and that it was time to cross the threshold.

If you touch and hold  
In the area of the text  
on the screen of the web  
browser 4 icons will be  
displayed at the top



Prometheus, in eternal punishment, is chained to a rock in the Caucasus, where his liver is eaten daily by an eagle,<sup>[4]</sup> only to be regenerated by night, which, by legend, is due to his immortality.<sup>[5]</sup> Years later, the Greek hero Heracles (Hercules) slays the eagle and frees Prometheus from his chains.<sup>[6]</sup>

Hesiod revisits the story of Prometheus in the *Works and Days* (lines 42–105). Here, the poet expands upon Zeus's reaction to the theft of fire. Not only does Zeus withhold fire from men, but "the means of life," as well (42). Had Prometheus not provoked Zeus's wrath (44–47), "you would easily do work enough in a day to supply you for a full year even without working; soon would you put away your rudder over the smoke, and the fields worked by ox and sturdy mule would run to waste." Hesiod also expands upon the *Theogony's* story of the first woman, now explicitly called Pandora ("all gifts"). After Prometheus' theft of fire, Zeus sent Pandora in retaliation. Despite Prometheus' warning,

If you touch and hold one of the icons next to the highlighted text you can drag across the screen to expand the highlighted text selection.

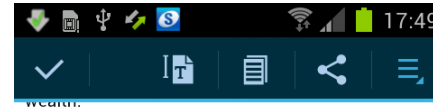

Prometheus, in eternal punishment, is chained to a rock in the Caucasus, where his liver is eaten daily by an eagle,<sup>[4]</sup> only to be regenerated by night, which, by legend, is due to his immortality.<sup>[5]</sup> Years later, the Greek hero Heracles (Hercules) slays the eagle and frees Prometheus from his chains.<sup>[6]</sup>

Hesiod revisits the story of Prometheus in the *Works and Days* (lines 42–105). Here, the poet expands upon Zeus's reaction to the theft of fire. Not only does Zeus withhold fire from men, but "the means of life," as well (42). Had Prometheus not provoked Zeus's wrath (44–47), "you would easily do work enough in a day to supply you for a full year even without working; soon would you put away your rudder over the smoke, and the fields worked by ox and sturdy mule would run to waste." Hesiod also expands upon the *Theogony's* story of the first woman, now explicitly called Pandora ("all gifts"). After Prometheus' theft of fire, Zeus sent Pandora in retaliation. Despite Prometheus' warning,

# General - Text Selection 2/3



✂ Text selecting options are moved to the top of screen



ICS (v4.0)

Example below shows Text selection when using WEB browser

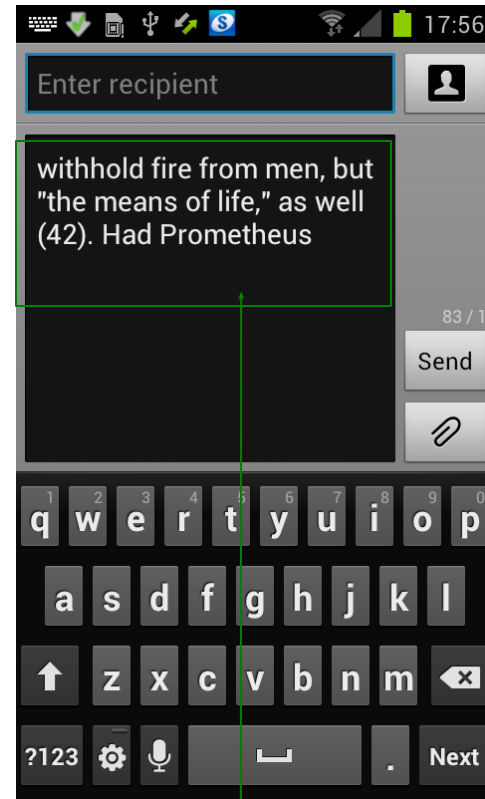
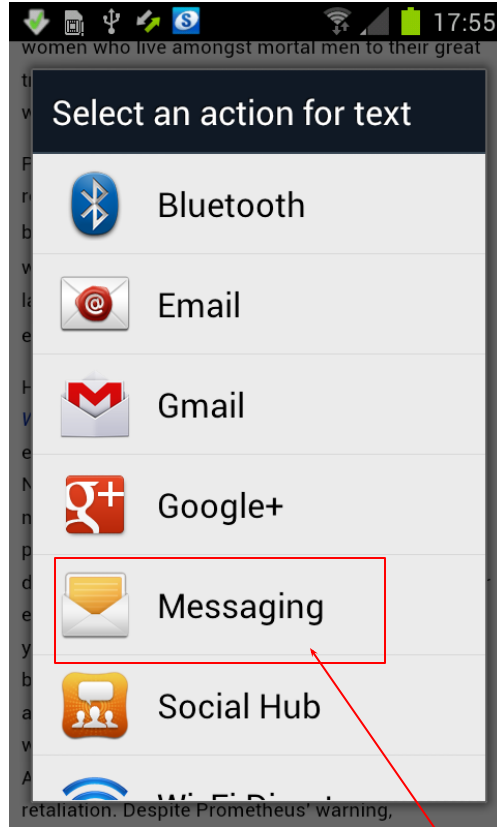
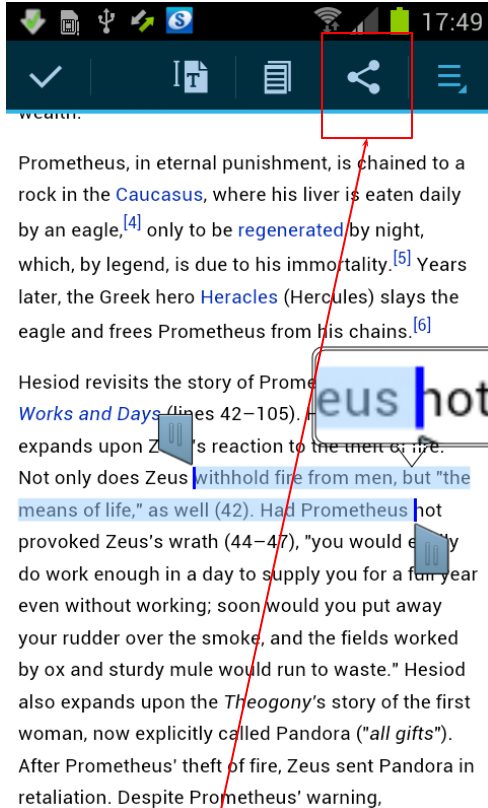

Tap on the Share icon to enable selected texts to be used by other applications e.g. **Messaging**

Selected text automatically pasted into the **Messaging Text box**





# Call – Icon, Contacts



✂ Call / Phone Menu User Interface (UI) now changed

Gingerbread (v2.3.6)

ICS (v4.0)

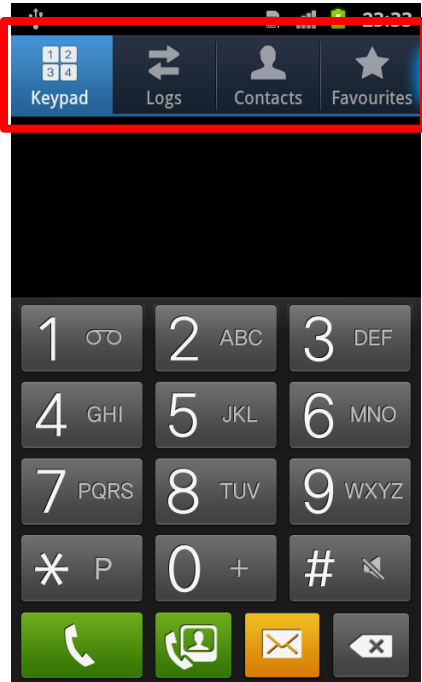

Phone “menu”

Changed to

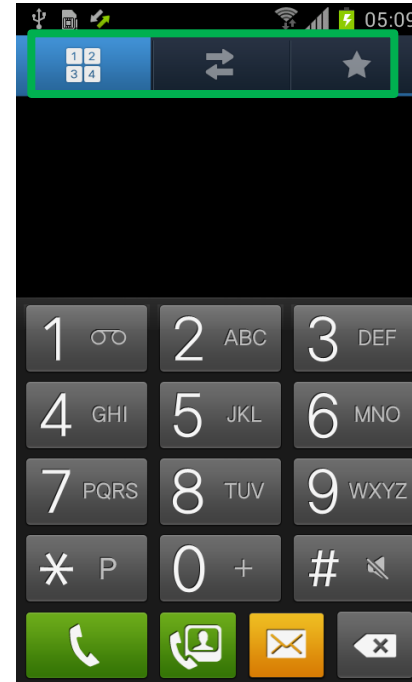
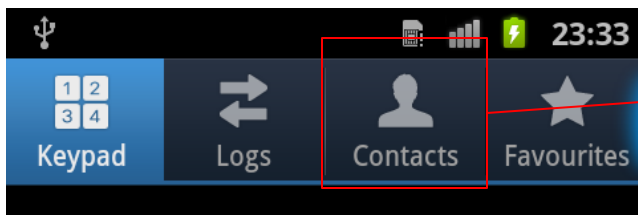

Phone “menu” changed.

Description for each tap and contacts tab are removed

**Contacts** Tab removed



# Call – Favorites



✘ Thumbnail used to display contacts in Favorites

## Gingerbread (v2.3.6)

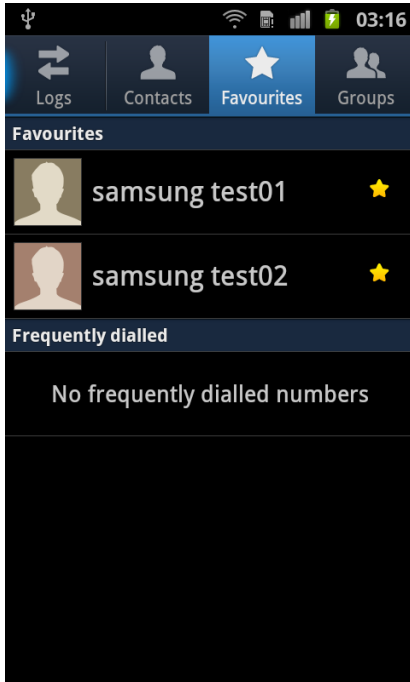

Contacts added to Favorites  
Shown in **Rows**

Changed to

## ICS (v4.0)

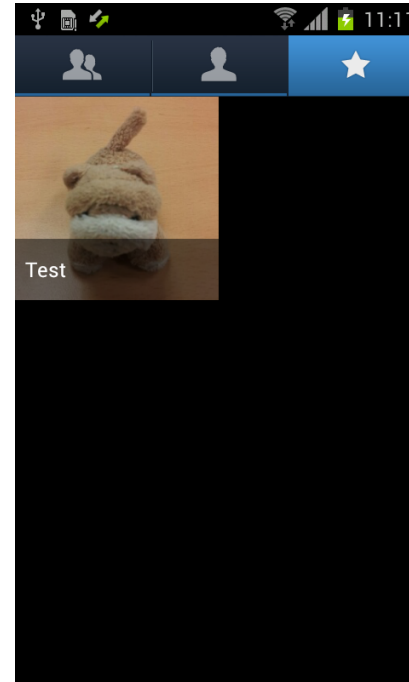

Favorites now shown as a  
Thumbnail with Contact name  
added in the thumbnail view

# Contacts – Save contact to



✘ “Save new contacts to” option removed

Gingerbread (v2.3.6)

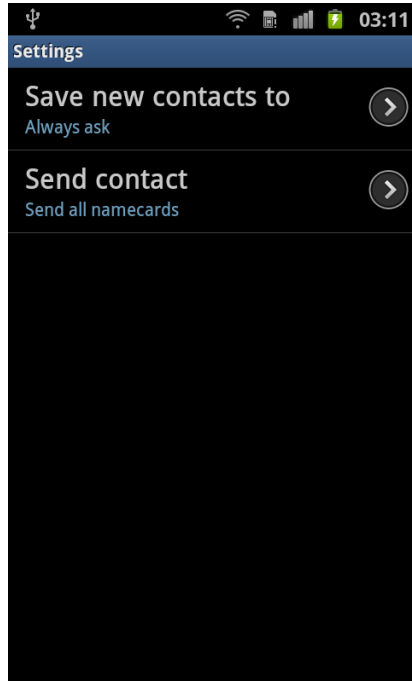

Contacts Settings - “Save new contact to” option available

ICS (v4.0)

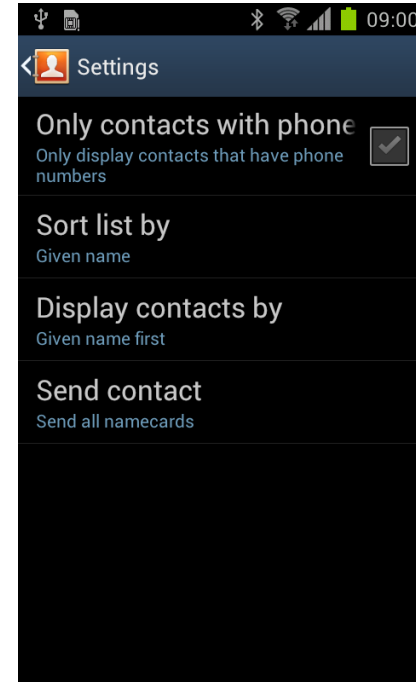

“Save new contacts to” options now removed

Changed to



# Message – Select a contact Icons



✘ Contact, Logs Icons now removed in “Select a contact” function

Gingerbread (v2.3.6)

ICS (v4.0)

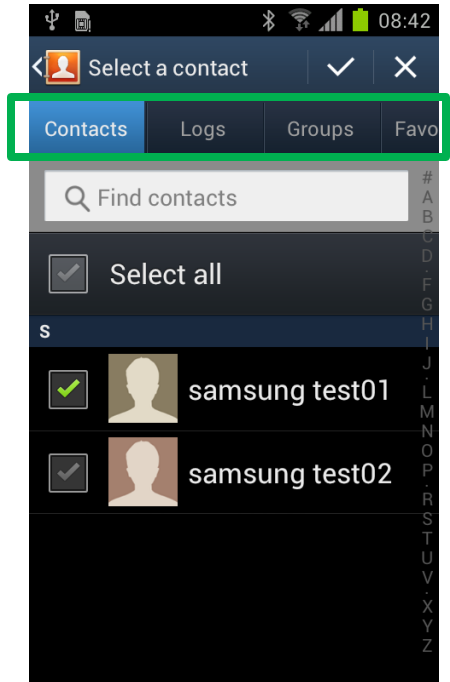
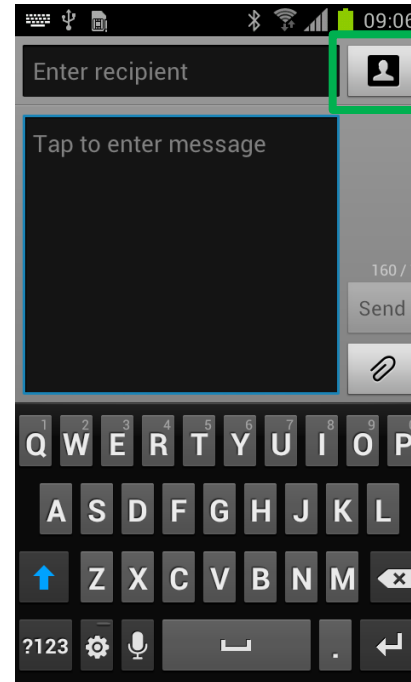
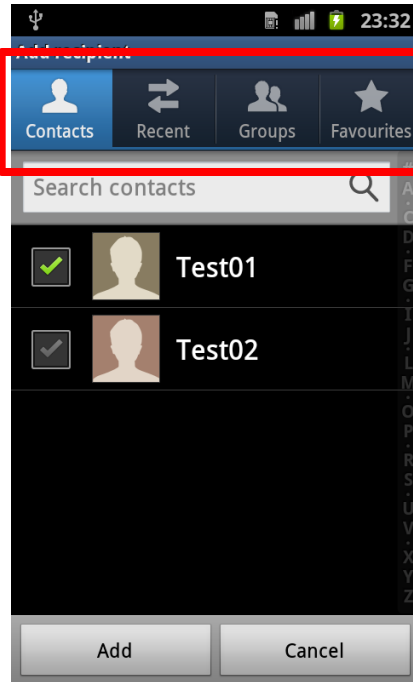
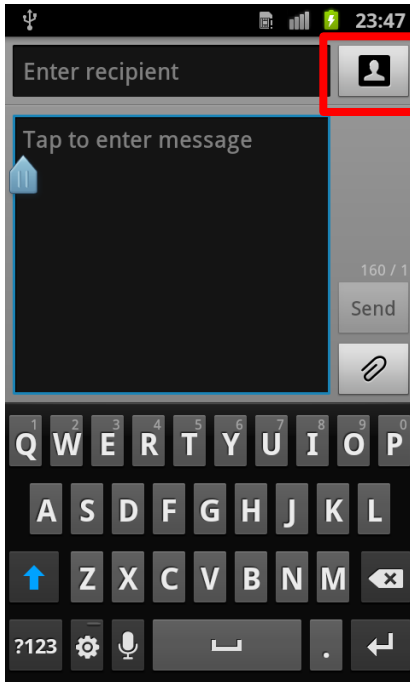

Icons displayed for Contacts / Recent (Call logs) Groups of Contacts., Logs

Icons now removed for Contacts / Recent (Call logs) Groups of Contacts., Logs

Changed to

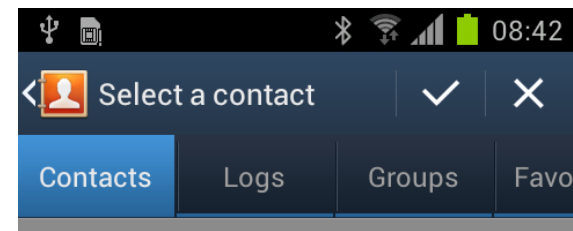
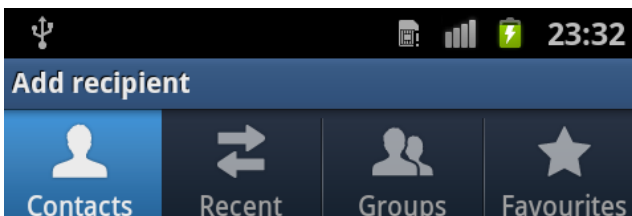

# Application – Unknown sources



✂ “Unknown sources” option is moved from Applications to Security

## Gingerbread (v2.3.6)

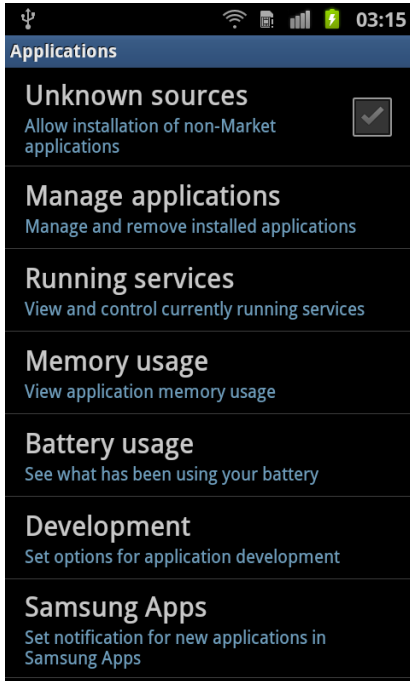

The setting to allow installations of applications not downloaded from Android Market (or Play) “**Unknown sources**” option located in **Applications Settings**

## ICS (v4.0)

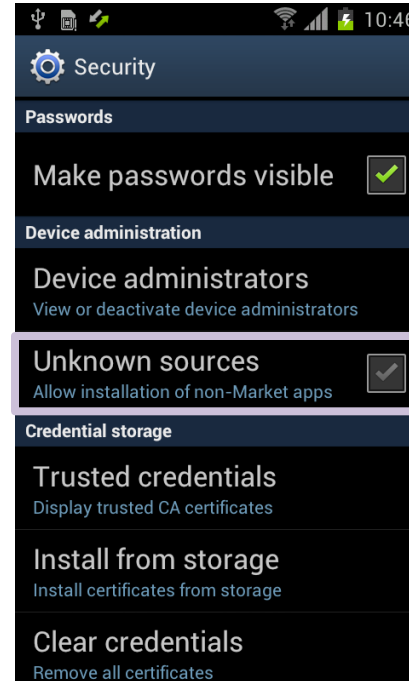

“Unknown sources” option is moved from Applications to Security

Changed to



# Setting – Settings



✂ Settings for Wireless and Network re-organised

Gingerbread (v2.3.6)

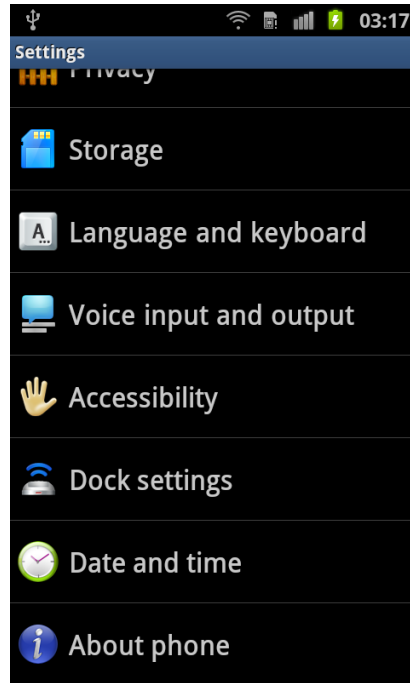
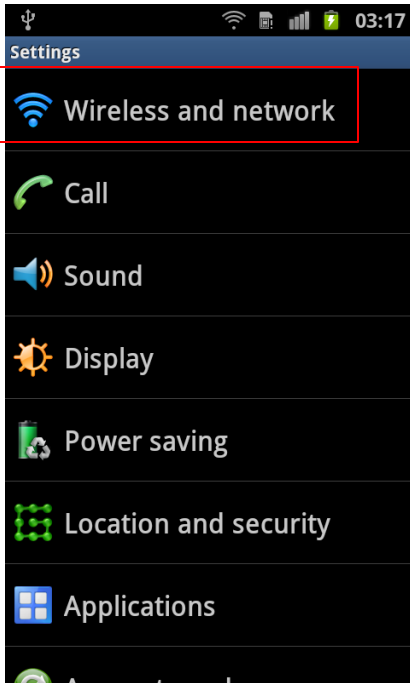

In settings area access to Wi-Fi Settings / Bluetooth and network settings are access via **“Wireless and Network”**

Changed to

ICS (v4.0)

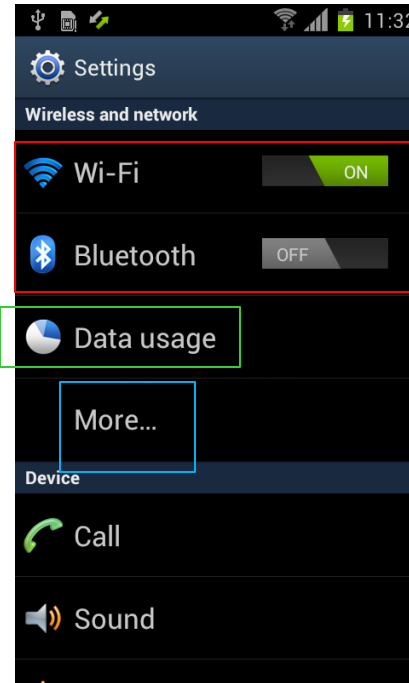

Wi-Fi/BT ON/OFF buttons are displayed instead of “wireless and network”  
Data usage function now added  
To access other network settings, click “More...”

Settings are categorized  
(Wireless & networks, Device, Personal, System)

Category name is changed (Privacy→Backup&reset)

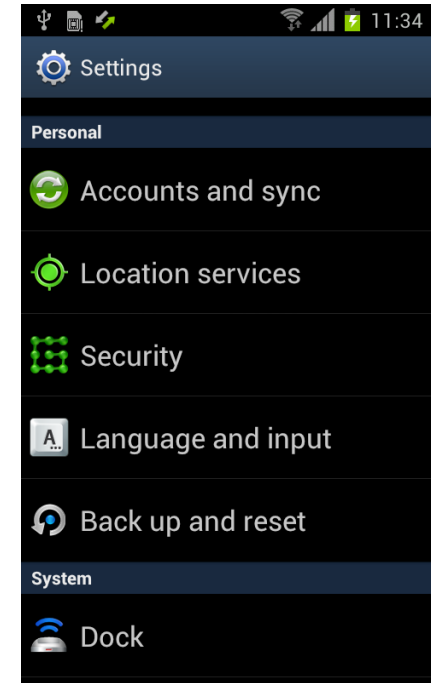

# Network Setting – Potable hotspot



✂ Additional security option added

Gingerbread (v2.3.6)

ICS (v4.0)

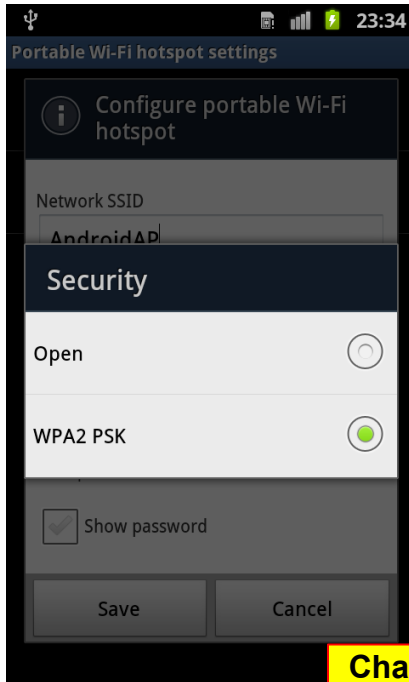

Open and WPA2 PSK options available

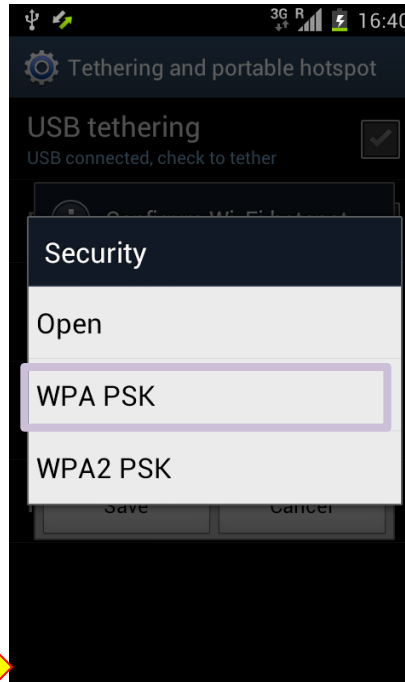

In Potable hotspot security option, “WPA PSK” is added

✂ WPA (Wi-Fi Protected Access)

WPA

- Pre shared Key (PSK)
- can use 802.1X authentication (EAP via RADIUS)

**NOT SUPPORTED:** TKIP encryption

- a possibility to use a form of AES-CCMP if the chipset on the network card, client supplicant, and router all support it

**WPA2**

- Pre shared Key (PSK)
- can use 802.1X authentication (EAP via RADIUS)
- TKIP encryption retained for backwards compatibility

**NOT SUPPORTED:** AES-CCMP encryption



# Network Setting - VPN



✂ Lock setting is needed to use VPN

Gingerbread (v2.3.6)

ICS (v4.0)

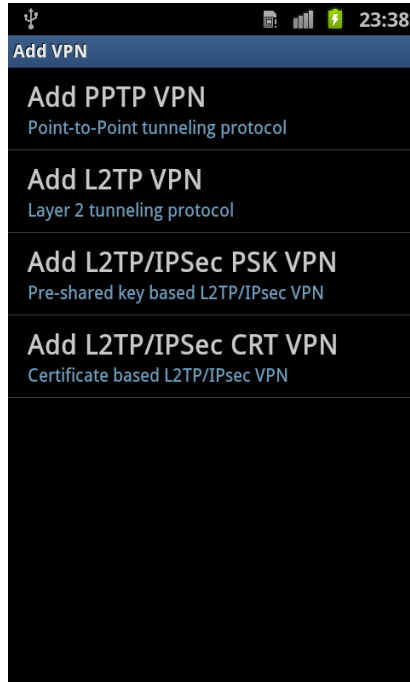
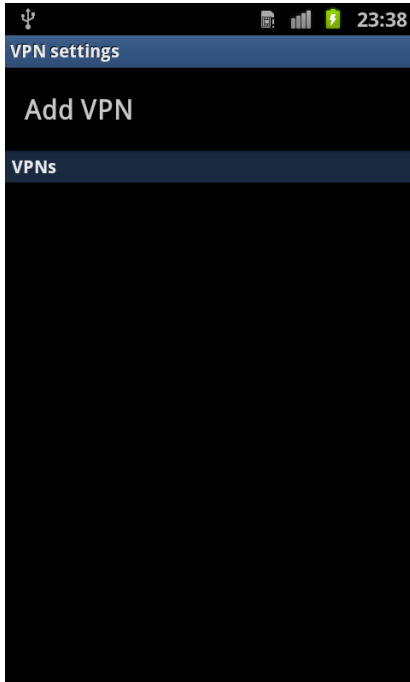

PIN or Pattern lock is not needed to access VPN options

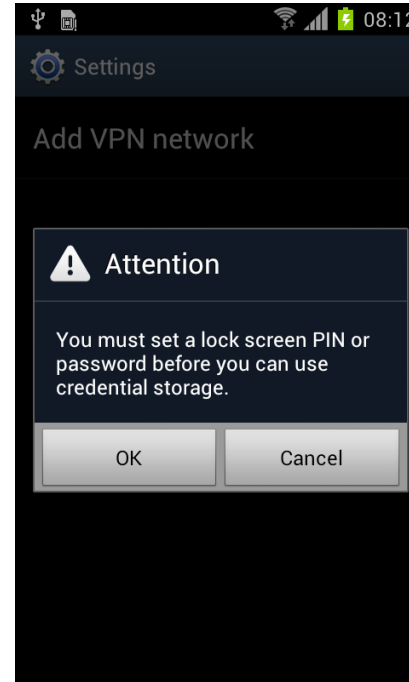

To use VPN network, Lock screen PIN or Password must be activated first

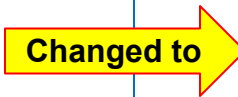
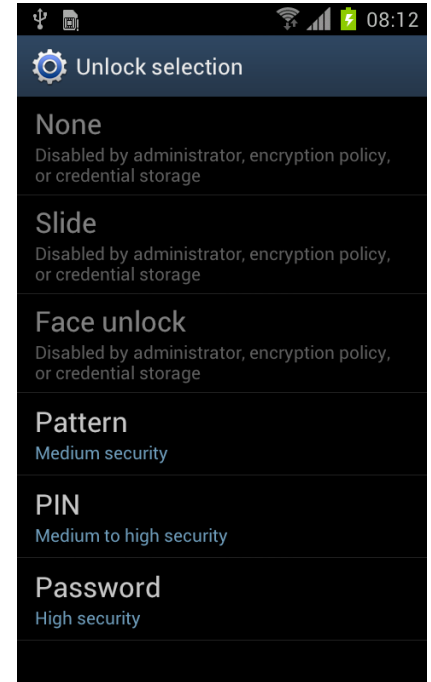

# Setting – Display



⌘ Display settings access now changed

## Gingerbread (v2.3.6)

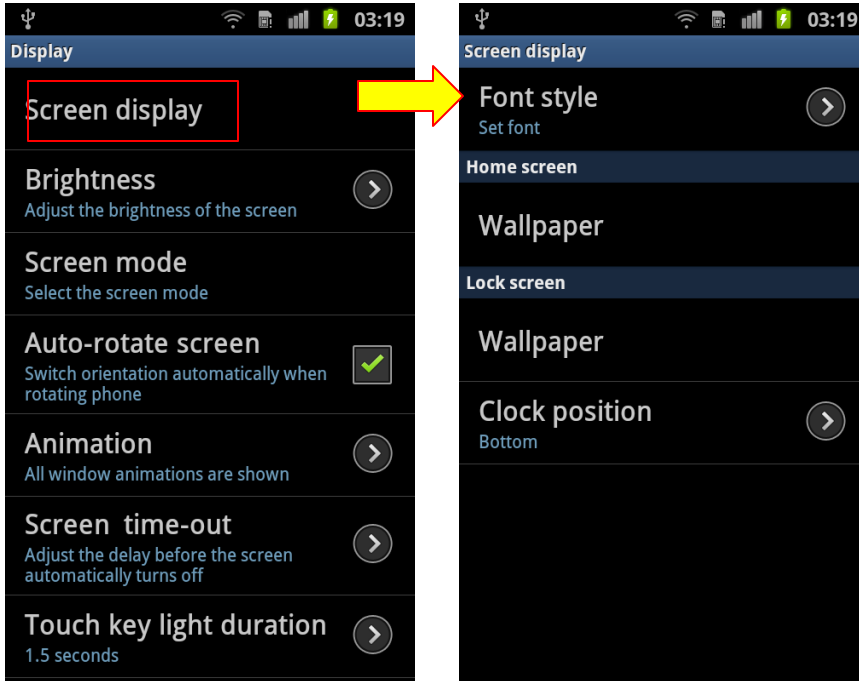

“**Screen display**” options (such as Font Style, Wallpaper etc) are accessed by entering the **Display\*** area in **Settings**, then tapping on Screen display

\* To start tap **Applications > Settings > Display > Screen display** > the screen display settings available will be listed

## ICS (v4.0)

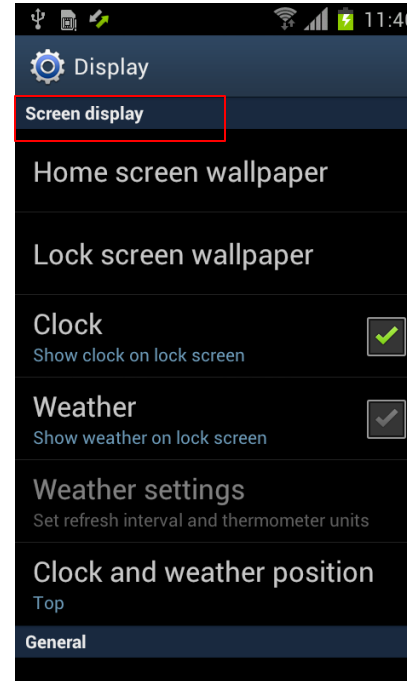

“Screen display” options available are now listed in the main display settings area

To start tap **Applications > Settings > Display > the screen display settings available will be listed**

Changed to 

# Setting – Applications



✂ Process to access “Manage applications” changed

## Gingerbread (v2.3.6)

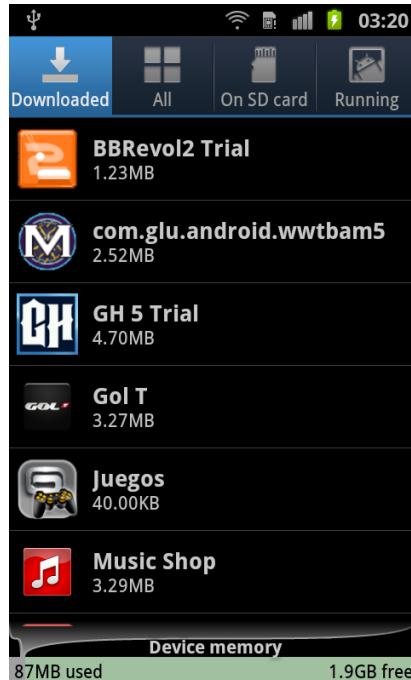
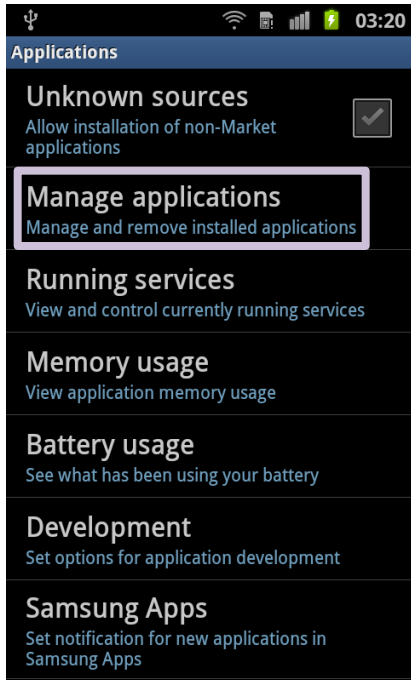

Options to “Manage applications” are accessed by process below:

To start tap **Applications > Settings > Applications > Manage Applications** > the screen will appear to manage your applications

## ICS (v4.0)

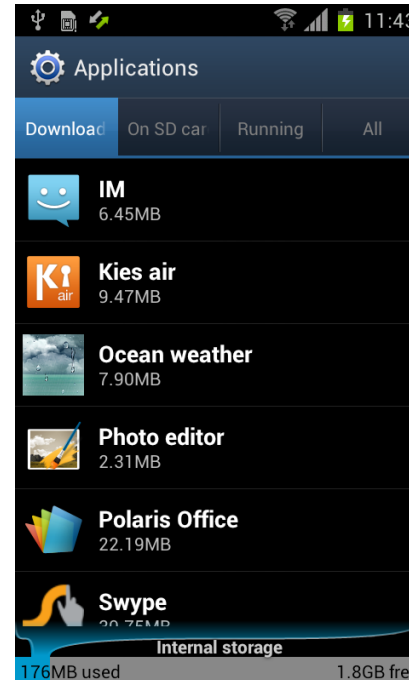

Options in “Manage applications” are moved to “Applications”

To start tap **Applications > Settings > Applications >** the screen will appear to manage your applications

Changed to

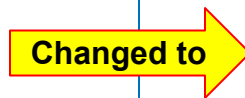

# Setting – Developer options



✂ Process to access “USB debugging” changed

## Gingerbread (v2.3.6)

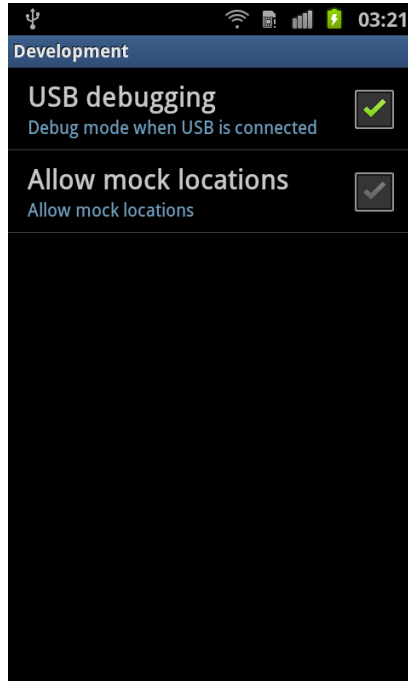
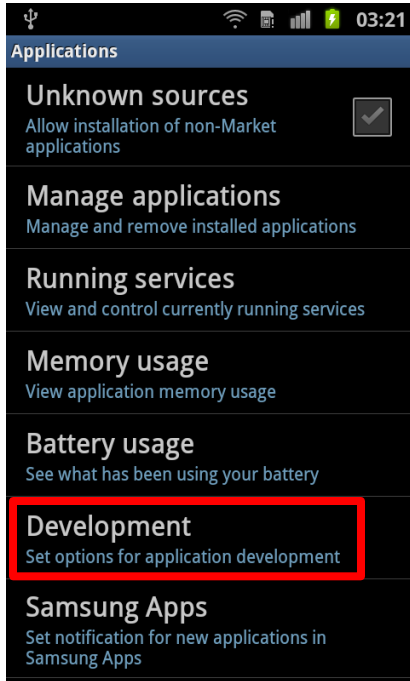

USB debugging accessed via:

To start tap **Applications > Settings > Applications > Development >**  
the screen will appear enable you to set USB debugging

## ICS (v4.0)

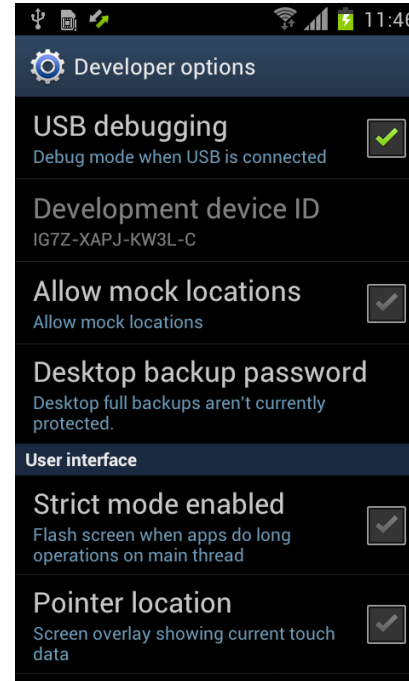

USB debugging and Allow mock locations options are moved to “Developer options”

To start tap **Applications > Settings > Developer Options >**  
the screen will appear enable you to set USB debugging

Changed to 

# Setting – Auto rotation



✂ Access to “Auto rotation” setting now moved to Accessibility settings area

## Gingerbread (v2.3.6)

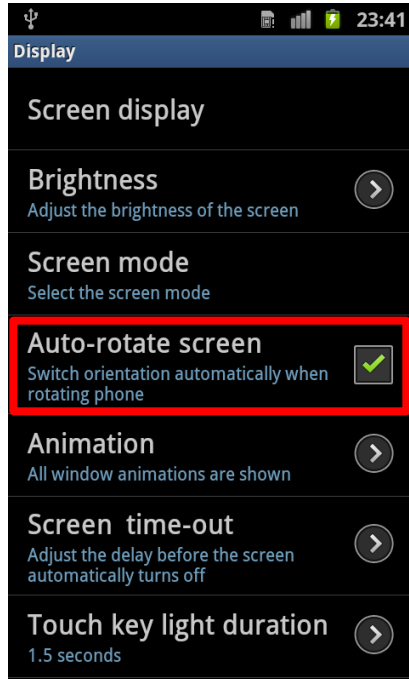

“Auto-rotation screen” setting located in “Display “setting

To start tap **Applications > Settings > Display > the screen** will appear enable you to set Auto Screen rotation

## ICS (v4.0)

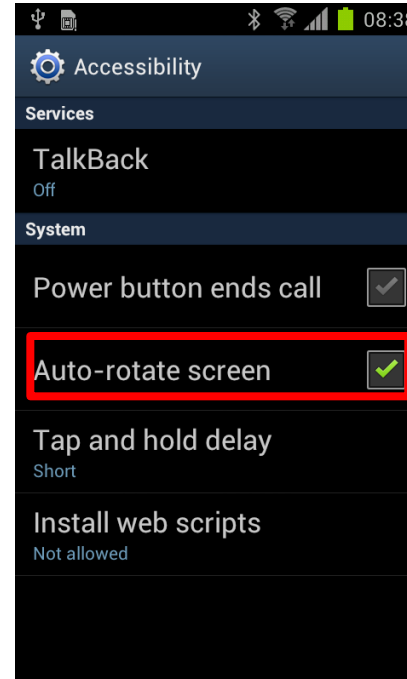

“Auto-rotation screen” setting is moved to Accessibility

To start tap **Applications > Settings > Accessibility > the screen** will appear enable you to set Auto Screen rotation

Changed to



# Screen lock – None



✂ The option “None” now added in Screen lock setting

ICS (v4.0)

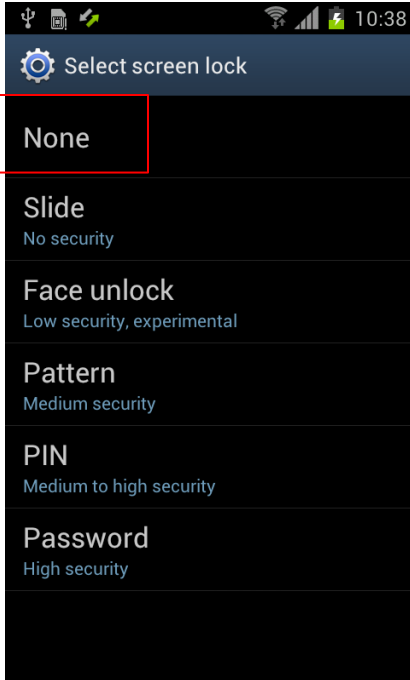

The “**None**” option now added in Screen lock settings area

**None** is no screen lock and enter to home screen

There are 6 kinds of screen lock:

None / Slide / Face Unlock / Pattern / PIN / Password

To start tap **Applications > Settings > Security > Screen Lock > the screen will appear enable you to set the Screen Lock type**

# Screen lock – Face



✂ “Face Unlock” feature now added in Screen lock setting

ICS (v4.0)

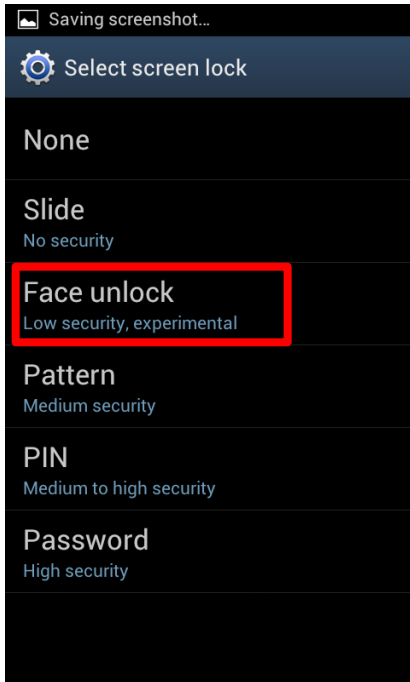

Select “Face Unlock” in Screen lock setting

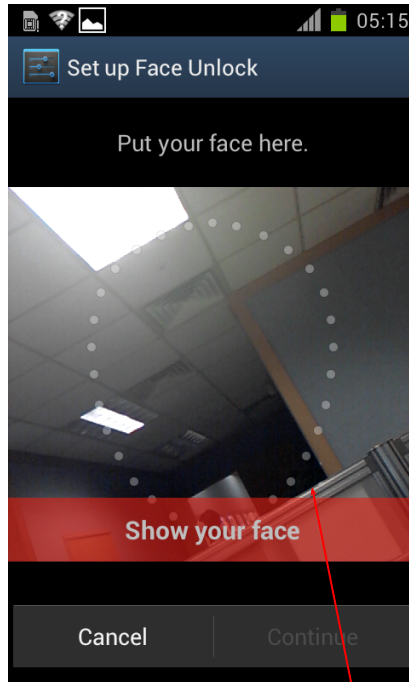

Allow your face to be seen using the front camera and adjust position of handset until your face is located in the circled area

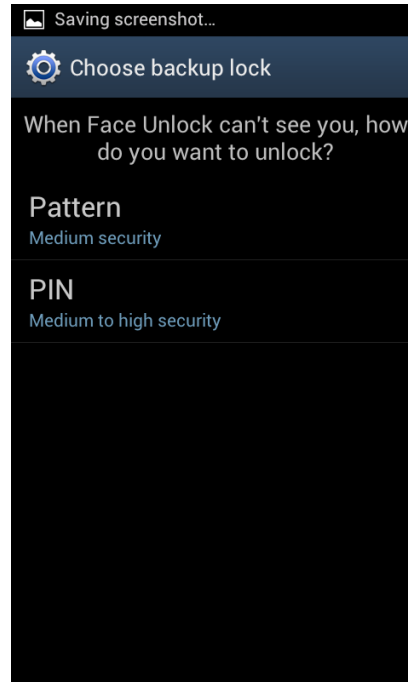

Configure Pattern or PIN to unlock your device when you have difficulty using “face unlock”

✂ To use pattern lock, you must select over 4 points (see next slide re use of Pattern lock)

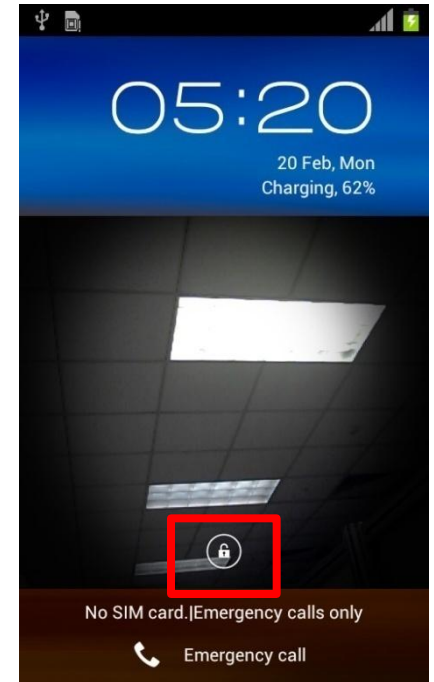

If you have trouble in “face unlock”, tap the “Lock” Icon and input the previously set up pattern or PIN

# Screen lock – Fail count



✘ Lock setting is needed to use VPN

ICS (v4.0)

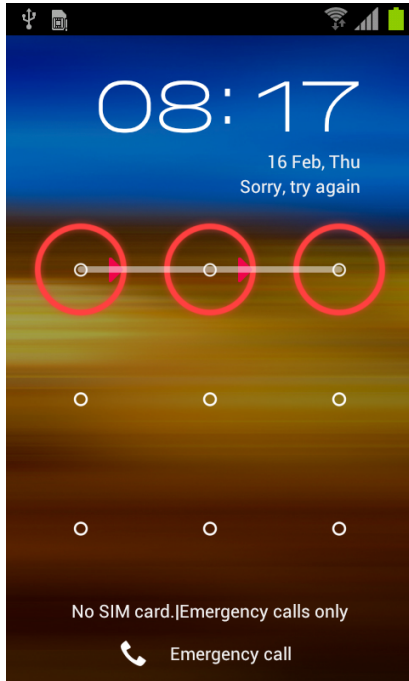

If you select three incorrect points or less in pattern lock screen, it's not counted.

(If you select 4 point or more **over 5 times in succession**, you must wait 30 seconds to input pattern again)

✘ To use pattern lock, you must select over 4 points



# Tips – Screen Capture



⌘ Key combination for perform screen capture now changed

Gingerbread (v2.3.6)



Power

Home

⌘ Screen capture Key combination  
- Press and hold **Home + Power**

ICS (v4.0)

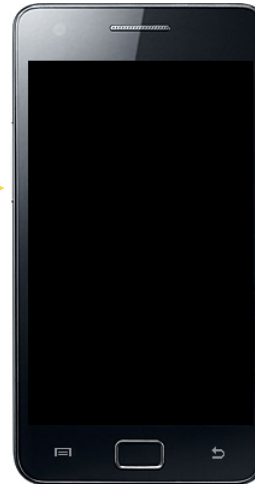

Volume Down

Power

⌘ Screen capture Key combination  
- Press and hold Volume Down + Power

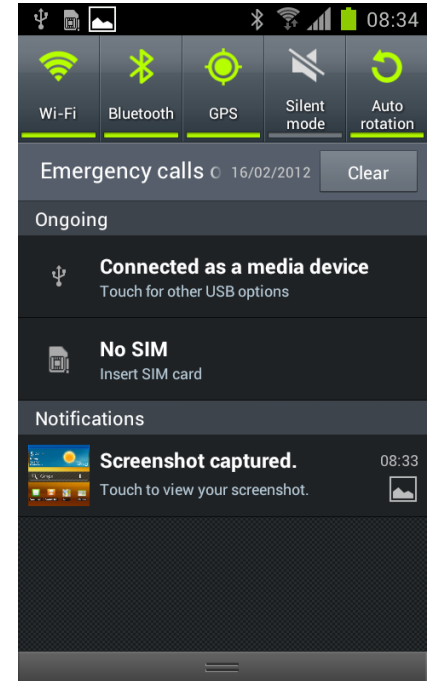

After screen capturing, screen capture icon is displayed in indicator bar

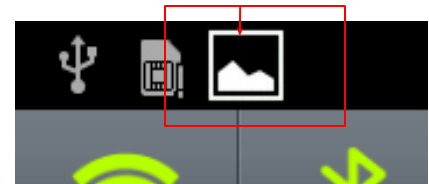

# END

## Customer Consultant Guide Android mobile technology platform

Global CS  
ECC HHP Review

Country : Europe  
Language : English

**SAMSUNG**